

Certificate number: CM40242 Rev2

Certification Body:

 ABN: 80 111 217 568
 JAS-ANZ Accreditation
 No. Z4450210AK
 PO Box 7144, Sippy
 Downs Qld 4556
 +61 (07) 5445 2199
www.CertMark.org

Certificate Holder:
 New Era Nominees T/As
 Masterwall Australia
 ABN 2141588731
 18-20 Cyber Loop
 Dandenong South,
 Victoria 3175
 Australia

www.masterwall.com.au

THIS IS TO CERTIFY THAT

Masterwall X-Series

Type and/or use of product:

Non-load bearing External Insulated Façade System.

Description of product:

X-Series is a non-load bearing integrated façade system for external walls comprising M Grade FR expanded polystyrene (EPS) and other proprietary components. The system can be either Batten Cavity Fixed or Direct-to-Frame Fixed. The panel is available in the following core thicknesses: 50mm, 75mm, 100mm and 125mm.

COMPLIES WITH THE FOLLOWING BCA PROVISIONS AND STATE OR TERRITORY VARIATION(S)

BCA 2019 (Amdt. 1)

	Volume One	Volume Two
Performance Requirement(s):	BP1.1(a)&(b)(iii) Structural reliability	P2.1.1(a)&(b)(iii) Structural stability and resistance to actions
	FP1.4 Weatherproofing	P2.2.2 Weatherproofing
	FP1.5 Rising damp	P2.2.3 Rising damp
Deemed-to-Satisfy Provision(s):	C1.10(a)(ix) Fire Hazard Properties	3.10.5.0 Application - limited to external wall cladding only in BAL not exceeding BAL A-29 - limited to panel thickness 75mm or greater
	G5.2 Protection - limited to external wall cladding only in BAL not exceeding BAL A-29 - limited to panel thickness 75mm or greater	3.12.1.4 Energy Efficiency – Contributes to the total R value. Refer A3
	J1.5 Energy Efficiency – Contributes to the total R value. Refer A3	
State or territory variation(s):	G5.2 (NSW)	3.10.5.0 (NSW)(QLD)

SUBJECT TO THE FOLLOWING LIMITATIONS AND CONDITIONS AND THE PRODUCT TECHNICAL DATA IN APPENDIX A AND EVALUATION STATEMENTS IN APPENDIX B

Limitations and conditions:

- This product has not been tested for non-combustibility. For Type A & B construction, the use of the Masterwall® X-Series Direct-to-Frame System must be supported by a site-specific Performance Solution where the BCA requires building elements and/or ancillary elements to be non-combustible. Acceptance or

Building classification/s:

1,2,3,4,5,6,7,8,9 & 10
 Note: Limited to Class C buildings.

 Richard Donarski - CMI

 Don Grehan – Unrestricted Building Certifier

Date of issue: 30/10/2020

Date of expiry: 23/10/2021



Certificate of Conformity

- otherwise of the site-specific Performance Solution is at the discretion of the appropriate Authority subject to the regulatory framework of the relevant State or Territory.
2. No assessment has been undertaken on the product for Part F6 of Vol 1 or Part 3.8.7 of Vol 2 of the 2019 BCA for Condensation management. A pliable building membrane complying with AS/NZS 4200.1:2017 must be installed in accordance with AS/NZS 4200.2:2017 to separate the wall cladding panels from any water sensitive materials.
 3. In all installations, the minimum clearance between the underside of panel and the adjoining surface level below must comply with the specifications in Part 3.5.4.7 of Volume 2 of the NCC.
 4. Compliance with BP1.1(b)(iii) & P2.1.1(b)(iii) excludes resistance to impact loading from windborne debris.
 5. In order to maintain compliance with BAL, it is the responsibility of the Building Designer to ensure compliance is achieved in accordance with AS 3959:2018.
 6. This certificate of conformity is limited to installations for non-cyclonic Design Ultimate Limit State Wind Pressures in accordance with AS/NZS 1170.2: 2011 (R2016) of +2.01 kPa, -3.01kPa. This includes AS 4055:2012 Wind Classification N1, N2, N3 & N4.
 7. The X-Series systems must be designed and installed in accordance with the relevant installation manual:
 - Batten Fixed: [X-SERIES System Installation & Construction Details – Batten Fixed System version 26.10.2020](#); or
 - Direct-To-Frame Fixed: [X-SERIES System Installation & Construction Details – Direct-To-Frame System version 02.10.2020](#).
 8. No substitution of any component part of the X-Series is permissible.
 9. In order to achieve compliance with weatherproofing in accordance with FV1.1 and V2.2.1, all window must comply with AS 2047:2014. The External wall applications required to achieve weatherproofing performance are limited to SLS wind pressures of +0.82kPa and -1.23kPa.
 10. The Thermal R values of the X-Series System will vary with installation configurations refer X-Series System install manuals.
 11. The X-Series System is only to be installed by a suitably qualified tradesperson or a builder.
 12. The X-Series System must incorporate either a timber frame constructed in accordance with AS 1684 series; or a cold-formed steel frame constructed in accordance with NASH Standard for Residential and Low-rise Steel Framing, Part 1:Design Criteria, or AS 3623-1993 (R2018) Domestic Metal Framing; or Framework compliant with other standards as applicable.
 13. The X-Series System consists of combustible components, it has not been tested and is not suitable for use as an FRL rated compliant system in accordance with AS 1530.4:2014 for boundary walls and/or party walls as a standalone walling system.
 14. Other than the information referenced in this Certificate of Conformity, the remainder of the information contained in the product's literature is outside the scope of this certification.
 15. The use of the certified product/system is subject to these Limitations and Conditions and must be read in conjunction with the Scope of Certification below.

Scope of certification: The CodeMark Scheme is a building product certification scheme. The rules of the Scheme are available at the ABCB website www.abcb.gov.au. This Certificate of Conformity is to confirm that the relevant requirements of the Building Code of Australia (BCA) as claimed against have been met. The responsibility for the product performance and its fitness for the intended use remain with the Certificate Holder. The certification is not transferrable to a manufacturer not listed on Appendix A of this certificate.

Only criteria as identified within this Certificate of Conformity can be used for CodeMark certification claims. Where other claims are made in a client's Installation Manual, Website or other documents that are outside the criteria on this Certificate of Conformity, such criteria cannot be used or claimed to meet the requirements of this CodeMark certification.

The NCC defines a Performance Solution as one that complies with the Performance Requirements by means other than a Deemed-to-Satisfy Solution. A Building Solution that relies on a CodeMark Certificate of Conformity that certifies a product against the Performance Requirements cannot be considered as Deemed-to-Satisfy Solution.



Certificate of Conformity

This Certificate of Conformity may only relate to a part of a Performance Solution. In these circumstances other evidence of suitability is needed to demonstrate that the relevant Performance Requirements have been met. The relevant provisions of the Governing Requirements in Part A of the NCC will also need to be satisfied.

This Certificate of Conformity is issued based on the evidence of compliance as detailed herein. Any deviation from the specifications contained in this Certificate of Conformity is outside of this document's scope and the installation of the certified product will not be covered by this Certificate of Conformity. This may result in the product being classified as a non-conforming building product.

Disclaimer: The Scheme Owner, Scheme Administrator and Scheme Accreditation Body do not make any representations, warranties or guarantees, and accept no legal liability whatsoever arising from or connected to, the accuracy, reliability, currency or completeness of any material contained within this certificate; and the Scheme Owner, Scheme Administrator and Scheme Accreditation Body disclaim to the extent permitted by law, all liability (including negligence) for claims of losses, expenses, damages and costs arising as a result of the use of the product(s) referred to in this certificate.

When using the CodeMark logo in relation to or on the product/system, the Certificate Holder makes a declaration of compliance with the Scope of Certification and confirms that the product is identical to the product certified herein. In issuing this Certificate of Conformity, CertMark International has relied on the experience and expertise of external bodies (laboratories and technical experts).

Nothing in this document should be construed as a warranty or guarantee by CMI, and the only applicable warranties will be those provided by the Certificate Holder.

APPENDIX A – PRODUCT TECHNICAL DATA

A1 Type and intended use of product

As per page 1.

A2 Description of product

Components

- X-Series EPS M Grade Fire Retardant 50mm, 75mm, 100mm and 125mm Panels
- iQuip - Fibreglass Mesh 160gsm – 55mm x 5mm
- MasterWall Breathable Sarking
- Tremco illbruck FM 330 - Polyurethane Foam
- Tremco EZY BOND - Construction Adhesive
- Fulaflex 650FC - Sealant
- Oranex OC2100 - Single Sided Butyl Nonwoven Fabric 0.75mm
- Ormonoid ABELROD – Closed Cell Polyethylene Foam Rod
- Aluminium Angle 30mm x 30mm x 0.42mm
- Wall Screws Galvanised Class 3, 10 Gauge Square Drive External Wall Screws
- Global Trading Supplies – Wall Screws Galvanised Class 3, 10 Gauge Square Drive External Wall Screws
- Master A-R-T - Pro Render
- Master A-R-T - Rendercoat Primer
- Master A-R-T - Texture Coating
- Master A-R-T Masterflex - Membrane Coating

Batten Fixed System:

X-Series Batten Fixed System is an M Grade expanded polystyrene (EPS) external wall panel, mechanically fixed to the outer face of the building. X-Series Batten Fixed system incorporates a cavity between the Breather Wrap and X-Series polystyrene panel to allow potential water ingress to drain from behind the cladding. The system includes the application of a three-layer polymer modified render system of minimum 6.5mm thickness, reinforced with fibreglass mesh embedded into the first layer of render.

Direct-to-Frame System:

X-Series Direct-to-Frame System is an M Grade expanded polystyrene (EPS) external wall panel, mechanically fixed to the outer face of the building. The system includes the application of a three-layer polymer modified render system of minimum 6.5mm thickness, reinforced with fibreglass mesh embedded into the first layer of render.

Batten Fixed System

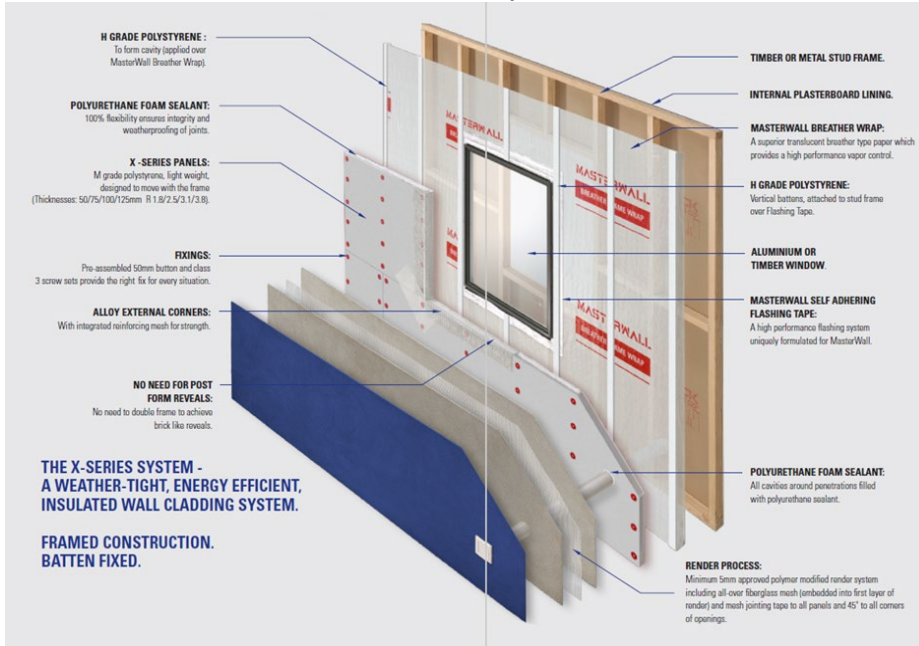

Direct-to-Frame System

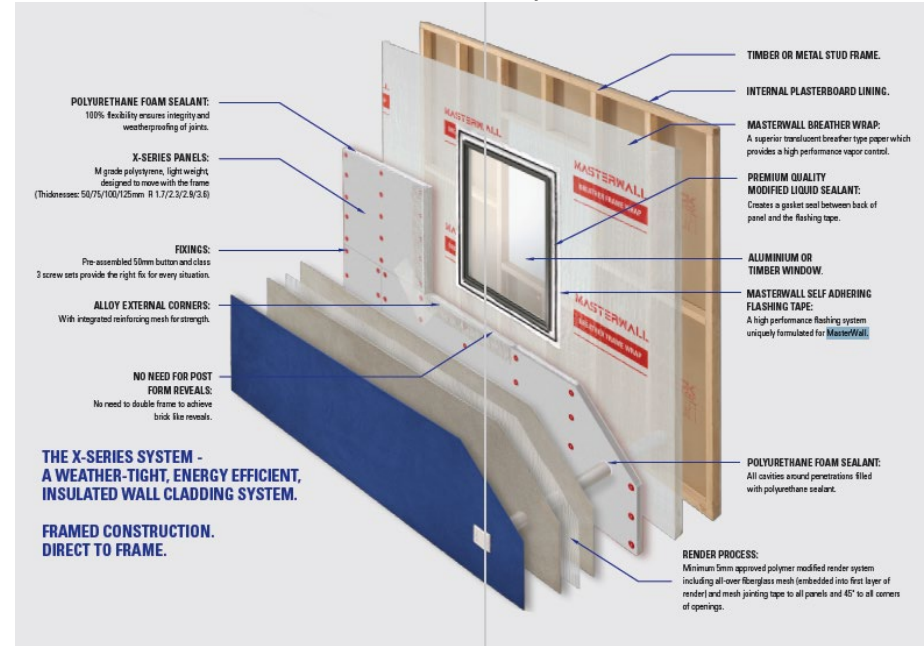

Source: X-Series Technical installation Manuals.

A3 Product specification

Structure	Limited to external wall applications where the design ultimate limit state wind pressure, calculated in accordance with AS/NZS 1170.2:2011(R2016) Structural Design Actions Part 2: Wind Actions, does not exceed +2.01 kPa and -3.01 kPa. This is deemed to include AS 4055-2012 wind classifications N1, N2, N3 & N4 and excludes AS 4055-2012 wind classifications, N5, N6, C1, C2, C3 & C4.		
Fire Hazard Properties	AS/NZS 1530.3-1999 Indices		
	Ignitability Index	5	Range 0-20
	Spread of Flame Index	0	Range 0-10
	Heat Evolved Index	1	Range 0-10
	Smoke Index	4	Range 0-10

Source: AWTA; NATA Accreditation No. 1356; Report No. 18-003571 dated 09/07/2018.

Certificate of Conformity

Bushfire Testing and assessments have been completed in accordance with AS 1530.8.1:2007, completed by Exova Warringtonfire, confirming BAL A-29 compliance. Compliance is achieved by incorporating a render system with minimum thickness 6.5mm, EPS thicknesses of 75mm or 100mm, and 160gsm fiberglass mesh. This report confirms approval of batten fix instead of direct fix of EPS panels with varying thicknesses from 10mm to 250mm.

Energy Efficiency Determined in accordance with AS/NZS 4859.1:2018 & AS/NZS 4859.2:2018 as follows:

Thickness	Panel Rating		Batten Fix		Direct Fix	
			Total R Value*		Total R Value**	
	Winter	Summer	Winter	Summer	Winter	Summer
50mm	1.3	1.2	2.0	1.9	1.8	1.7
75mm	2.0	1.9	2.6	2.5	2.5	2.3
100mm	2.7	2.5	3.3	3.2	3.1	3.0
125mm	3.3	3.1	4.0	3.8	3.8	3.6

*The complete system R rating including X-Series panel, cavity, breather wrap, stud frame cavity and 10mm plasterboard.

**The complete system R Rating including X-Series panel, breather wrap, stud frame cavity and 10mm plasterboard.

Weatherproofing Weatherproofing testing conducted to AS/NZS 4284:2008 with performance is limited to SLS wind pressures of +0.82kPa and -1.23kPa and wind classifications N1, N2, N3 & N4.

Source: Ian Bennie and Associates Test Report No. 2018-051-S2 dated 26/07/2018.

A4 Manufacturer and manufacturing plant(s)

New Era Nominees
Trading as MasterWall Australia
18-20 Cyber Loop,
Dandenong South, Victoria 3175
Australia.

A5 Installation requirements

Masterwall X-Series installation shall be in strict accordance with relevant the installation manual:

- Batten Fixed: [X-SERIES System Installation & Construction Details – Batten Fixed System version 26.10.2020](#); or
- Direct-To-Frame Fixed: [X-SERIES System Installation & Construction Details – Direct-To-Frame System version 02.10.2020](#).

A6 Other relevant technical data

No other relevant technical data.

APPENDIX B – EVALUATION STATEMENTS

B1 Evaluation methods

1. Fire Safety Provisions A5.2(1)(d)&(e). Reports from Accredited Testing Laboratories and a professional engineer.
2. Structural Provisions A5.2(1)(e). Reports from a professional engineer.
3. Thermal Provisions A5.2(1)(e). Reports from a professional engineer.
4. Weatherproofing Provision A5.2(1)(d)&(e). Reports from Accredited Testing Laboratories and a professional engineer.

B2 Reports

1. Acronem Consulting Australia Pty Ltd; Report ACA 180716; Masterwall X-SERIES DIRECT-TO-FRAME System NCC 2019 Amdt.1; Dated 16/07/2020.
2. Acronem Consulting Australia Pty Ltd; Report ACA 180810; Masterwall X-SERIES BATTEN FIX System NCC 2019 Amdt.1; Dated 05/08/2020.
3. AWTA Product Testing; NATA Accreditation No. 1356; Test Report No. 18-003571; Testing in accordance with AS/NZS 1530.3-1999, fire indices; Dated 09/07/2018.
4. CSIRO; NATA Accreditation No. 165; Report No. CMIT(C)-2005-516; Masterwall Cladding Bending, Shear and Fastening Testing; November 2005.
5. Exova Warringtonfire; NATA Accreditation No. 3277; EWFA Report No: 52433000.1; Bushfire Attack Level; Dated 12/09/2018.
6. Exova Warringtonfire; NATA Accreditation No. 3277; Report No: FAS 180357.3; An assessment of the bushfire resistance of a MasterWall X-Series direct fixed rendered panel wall system when tested in accordance with AS 1530.8.1-2007; Dated 02/10/2018.
7. Ian Bennie and Associates; NATA Accreditation No. 2371; Test Report No. 2018-051-S2; MasterWall Cladding System - Direct Fixed, Specimen Tests to Verification Methods NCC-2016 FV1 and V2.2.1 for MasterWall Pty Ltd; Dated 26/07/2018.

The Certificate Holder has chosen not to make the above evidence of compliance publicly available, due to the documents being considered commercial in confidence.